



PARTS BREAKDOWN AND OPERATING MANUAL

OWNER/USER RESPONSIBILITY:

The owner and/or user must have a thorough understanding of the manufacturer's operating instructions and warnings before using the lift. Personnel involved in the use and operation of equipment shall be careful, competent, trained, and qualified in the safe operation of the equipment and its proper use when servicing motor vehicles and their components. Warning information should be emphasized and understood. If the operator is not fluent in English, the manufacturer's instructions and warnings shall be read to and discussed with the operator in the operator's native language by the purchaser/owner, making sure that the operator comprehends its contents.

Owner and/or user must study and maintain for future reference the manufacturer's instructions and pertinent warning information. Owner and/or user is responsible for keeping all warning labels and instruction manuals legible and intact. Replacement labels and literature are available from the manufacturer.

MAINTENANCE AND INSPECTION:

Visual inspection should be made before each use of the lift, checking for leaking hydraulic fluid and damaged, loose or missing parts. Each lift must be inspected by a manufacturer's repair facility immediately, if accidentally subjected to an abnormal load or shock. Any lift which appears to be damaged in any way, found to be badly worn, or operates abnormally **MUST BE REMOVED FROM SERVICE** until necessary repairs are made by a manufacturer's authorized repair facility. It is recommended that an annual inspection of the lift be made by a manufacturer's authorized repair facility and that any defective parts, decals or warning labels be replaced with manufacturer's specified parts.

A list of authorized repair facilities is available from the manufacturer.



THIS OPERATING MANUAL CONTAINS IMPORTANT SAFETY INFORMATION. READ CAREFULLY AND UNDERSTAND ALL INFORMATION BEFORE OPERATING TOOL. SAVE THIS MANUAL FOR FUTURE USE.

PRIOR TO OPERATION:

1. Press release pedal.
2. Pump foot pedal 6 full strokes to purge the air from the pump and valving.
3. Remove foot from release pedal.
4. Pump the foot pedal until the jack has reached full extension. Continue to pump several times to purge air from under the ram.
5. Press release pedal and push ram into its lowest position. Take foot off release pedal and operate normally.

Note: If the jack responds immediately to pump action, it is free of air and ready for operation. If not, repeat procedure.

SPECIFICATIONS:

Capacity	1500 Lbs. Maximum
Minimum Height	.4-3/4"
Maximum Height	.16-1/2"
Base Size	.17" x 36-1/4"
Shipping Weight	.101.4 Lbs.

⚠WARNING

<p>DO NOT EXCEED LOAD RATING OF 1500 LBS. SECURE LOAD TO TIE-DOWN LOOPS. USE ONLY ON HARD LEVEL SURFACES CAPABLE OF SUPPORTING THE LOAD. USE ON OTHER THAN HARD, LEVEL SURFACES MAY RESULT IN POSSIBLE LOSS OF LOAD. NO ALTERATIONS TO THE ATV/MOTORCYCLE LIFT SHALL BE MADE.</p>	<p>READ, STUDY AND UNDERSTAND THE OPERATING MANUAL PACKED WITH THIS LIFT BEFORE OPERATING JACK AND/OR LIFT. FAILURE TO HEED THESE WARNINGS MAY RESULT IN LOSS OF LOAD, DAMAGE TO THE LIFT, AND/OR FAILURE RESULTING IN PROPERTY DAMAGE, PERSONAL OR FATAL INJURY.</p>
--	---

ASSEMBLY INSTRUCTIONS:

1. Secure the hydraulic ram (Part #20) to the base frame with the screws provided. Make sure the release valve is facing outside the frame.
2. Insert the foot pedal (Part #21) into the hole over the pump piston and secure it with the bolt (Part #22). Insert a pivot pin through the two holes in front of the release valve and through the release valve pedal. Secure it with the hair pin provided.
3. Place the safety bar (Part #28) inside the load frame and align them with the holes on the frame. Insert two securing bolts through the three of them and secure it with the hair pin provided.
4. Raise the load frame by hand and align the head of the hydraulic ram with the holes in the middle of the load frame. Secure it with the pivot pin (Part #24) provided.
5. Insert the pulling handle (Part #26) into the hole on the outside of the load frame and turn the handle to lock into place.

OPERATING INSTRUCTIONS:

1. Make sure lift is on solid, level surface before use.
2. Adjust jack position to make sure the ATV or motorcycle is centered before lifting.
3. To raise, pump foot pedal (Part #21).
4. Engage the safety bar once the load has reached its desired height.
5. Before performing any maintenance or adjustments on ATV or motorcycles, secure the load to lift by connecting two tie down straps supplied with lift to eyelets on the frame and hooking other end of straps into eyelets on opposite end of frame. Adjust straps using clamp until snug.
6. Before lowering, disengage the safety bar by pulling the bar toward the load frame (Part #25). Loosen and remove tie down straps.
7. To lower, press the release valve pedal (Part #17) slowly.

LIMITED WARRANTY:

SUNEX INTERNATIONAL, INC. WARRANTS TO ITS CUSTOMERS THAT THE COMPANY'S SUNEX TOOLS® BRANDED PRODUCTS ARE FREE FROM DEFECTS IN WORKMANSHIP AND MATERIALS.

Sunex International, Inc. will repair or replace its Sunex Tools® branded products which fail to give satisfactory service due to defective workmanship or materials, based upon the terms and conditions of the following described warranty plans attributed to that specific product.

This product carries a ONE-YEAR warranty. During this warranty period, Sunex Tools will repair or replace at our option any part or unit which proves to be defective in material or workmanship.

Other important warranty information...

This warranty does not cover damage to equipment or tools arising from alteration, abuse, misuse, damage and does not cover any repairs or replacement made by anyone other than Sunex Tools or its authorized warranty service centers.

The foregoing obligation is Sunex Tools' sole liability under this or any implied warranty and under no circumstances shall we be liable for any incidental or consequential damages.

Note: Some states do not allow the exclusion or limitation of incidental or consequential damages, so the above limitation or exclusion may not apply to you.

Return equipment or parts to Sunex Tools, transportation prepaid. Be certain to include your name and address, evidence of the purchase date, and description of the suspected defect.

If you have any questions about warranty service, please write to Sunex Tools. This warranty gives you specific legal rights and you may also have other rights which vary from state to state.

Repair kits and replacement parts are available for many of Sunex Tools products regardless of whether or not the product is still covered by a warranty plan.

SHIPPING ADDRESS: Sunex Tools • 315 Hawkins Rd. • Travelers Rest, South Carolina 29690

MAILING ADDRESS: Sunex Tools • P.O. Box 4215 • Greenville, South Carolina 29608

MODEL # 6615
1500 Lb. Capacity
ATV Lift

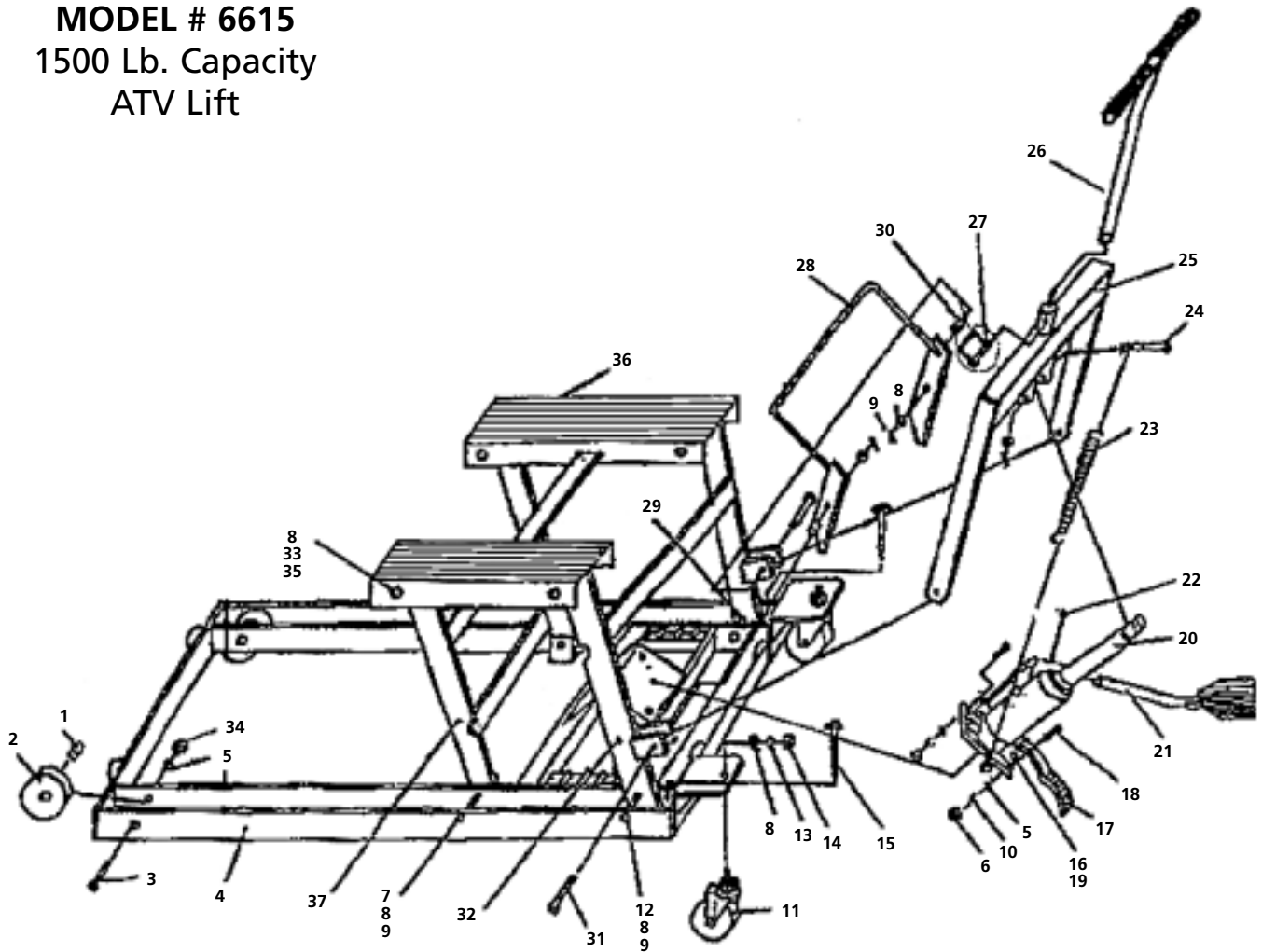

REF NUMBER	PART NUMBER	DESCRIPTION	QTY.	REF NUMBER	PART NUMBER	DESCRIPTION	QTY.
1		Sleeve Bearing	2	20	RS661520	3 Ton Ram	1
2	RS661502	Wheel (with sleeve bearing)	2	21	RS661521	Foot Pedal	1
3		Bolt M8 x 65	2	22		Bolt M8 x 20	1
4		Base	1	23	RS661523	Spring	1
5		Washer 8	4	24		Lock Pin	1
6		Nut M8	2	25		Load Frame	1
7		Pin 1	2	26		Handle	1
8		Washer 12	15	27		Clevis Pin 14 x 60	1
9		Split Pin	7	28		Safety Bar	1
10		Spring Washer 8	2	29		Washer 1	2
11	RS661511	3" Caster	2	30		Washer 2	2
12		Pin 2	2	31		Pin 3	2
13		Spring Washer 12	2	32		Rear Strut Linkage	1
14		Nut M12	2	33		Lock Nut M12	4
15	RS661515	Wheel Stop Bolt	2	34		Lock Nut M8	2
16		Pin	1	35		Bolt M12 x 115	4
17	RS661517	Release Pedal	1	36	RS661536	Platform	2
18		Bolt M8 x 20	1	37		Front Strut Linkage	1
19		C-clip 8	1	Not Shown	RS6615TD	Tie Down Strap	2