



# 8258 1,250 Lb. Engine Stand

### **SPECIFICATIONS:**

Capacity	1250 Lbs.
Length	33-1/4"
Width	33-1/2"
Height	33-1/2"
Shipping Weight	88 Lbs. 2 Boxes

### **!WARNING**



**DO NOT OVERLOAD. OVERLOADING CAN CAUSE DAMAGE TO, OR FAILURE OF THE STAND.**

**THIS STAND IS DESIGNED FOR USE ONLY ON HARD LEVEL SURFACES CAPABLE OF SUPPORTING THE LOAD. USE ON OTHER THAN HARD LEVEL SURFACES CAN RESULT IN STAND INSTABILITY AND TIPPING OF LOAD.**

**LOCK THE MOUNTING-PLATE ROTATING MECHANISM BEFORE APPLYING A LOAD. RELEASE ROTATIONAL LOCKING DEVICE SLOWLY AND CAREFULLY.**

**ALWAYS USE HIGH STRENGTH SAE GRADE 8 BOLTS FOR ENGINE MOUNTING BOLTS.**

**MAKE SURE WIDEST SET OF MOUNTING HEAD FINGERS ARE NEAREST THE GROUND WHEN MOUNTING AN ENGINE TO THE STAND.**

**ALWAYS BE SURE THAT THE LOAD IS CENTERED AND SECURED TO THE MOUNTING PLATE. OFF-CENTER LOADS MAY MAKE THE LOAD AND HANDLE ROTATE IN EITHER DIRECTION WHEN THE ROTATIONAL LOCKING DEVICE IS RELEASED.**

**NEVER LOOSEN MOUNTING BOLTS UNLESS ENGINE IS SUPPORTED BY A CRANE OR HOIST.**

**DO NOT USE STAND TO DOLLY OR TRANSPORT ENGINES.**

**NO ALTERATIONS TO THE STAND OR ADAPTERS SHALL BE MADE.**

**DO NOT ROTATE MOTOR UNLESS REAR LEGS ARE SECURED FROM TIPPING.**

**READ, STUDY AND UNDERSTAND ALL INSTRUCTIONS BEFORE OPERATING.**

**FAILURE TO HEED THESE WARNINGS MAY RESULT IN LOSS OF LOAD, DAMAGE TO STANDS, AND/OR FAILURE RESULTING IN PROPERTY DAMAGE, PERSONAL OR FATAL INJURY.**

### **Features:**

- U-Shaped Design Provides Added Stability
- Adjustable Locking Mechanism Allows 360° Rotation of Engine
- Sturdy 4-Wheel Design

### **Owner/User Responsibility:**

The owner and/or user must have a thorough understanding of the manufacturer's operating instructions and warnings before using this engine stand. Personnel involved in the use and operation of equipment shall be careful, competent, trained, and qualified in the safe operation of the equipment and its proper use when servicing motor vehicles and their components. Warning information should be emphasized and understood. If the operator is not fluent in English, the manufacturer's instructions and warnings shall be read to and discussed with the operator in the operator's native language by the purchaser/owner, making sure that the operator comprehends its contents.

Owner and/or user must study and maintain for future reference the manufacturer's instructions. Owner and/or user is responsible for keeping all warning labels and instruction manuals legible and intact. Replacement labels and literature are available from the manufacturer.

### **!WARNING**

**Do not crawl under engine or place any part of your body under engine at any time during mounting of engine, use of stand, or removal of engine.**

**Refer to Engine Service Manual for Correct Lifting Points, Mounting Points and Mounting Bolts! Mounting bolts should be torqued at appropriate amount to maintain load.**

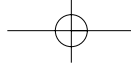

## Assembly Instructions:

1. First, ensure shaft jacket (#19) is inside hub of both rear wheels (#5). Attach rear wheels (#5) to base legs (#3) using (2) 1/2" x 2-1/2" HHCS (#25), (2) 1/2" locking washer (#23) and (2) 1/2" hex nuts (#14). Then, attach front swivel casters (#4) to base legs (#3) using (4) 5/16" x 3/4" HHCS (#15) and (4) 5/16" washers (#16).
2. Attach base legs (#3) to base (#6) first using (4) 1/2" x 3-1/4" HHCS (#21), (4) 1/2" washers (#24) and (4) 1/2" hex nuts (#14). Now, secure by using (2) 1/2" x 1-1/4" HHCS (#22), (2) 1/2" washers (#24), and (2) 1/2" hex nuts (#14).
3. Attach post (#8) to base (#6) using (4) 1/2" x 3-1/4" HHCS (#21), (4) 1/2" washers (#24) and (4) 1/2" hex nuts (#14).  
Note: Do not tighten post securely until the straps have been attached to both the base and post.
4. Insert head (#20) into post (#8) and secure by threading (1) 1/2" x 1" HHCS (#11) into the threaded nut on top of post. Tighten so head will not rotate.
5. Attach bottom of straps (#7) to base (#6) using (2) 1/2" x 1-1/4" HHCS (#18), (2) 1/2" washers (#24) and (2) 1/2" hex nuts (#14). Then, attach top of straps (#7) to post (#8) using (1) 1/2" x 3-1/2" HHCS, (1) 1/2" washer (#24) and (1) 1/2" hex nut (14).
6. Attach two short fingers (#1) to head using (2) 1/2" x 3" HHCS (#12), (2) 1/2" USS thick washers (#13), (2) 1/2" 1/2" lock washers (#23), (2) 1/2" washers (#24) and (2) 1/2" hex nuts (#14). Now attach two long fingers (#2) using (2) 1/2" x 3" HHCS (#12), (2) 1/2" USS thick washers (#13), (2) 1/2" lock washers (#23), (2) 1/2" washers (#24) and (2) 1/2" hex nuts (#14).
7. Insert handle (#10) into hole at back of head (#20) and slide handle grips (#9) onto each end of handle.
8. Check all nuts and bolts for tightness before operating.

## Operating Instructions:

Drain oil and coolant and remove flywheel from engine before mounting. Mount engine as directed in procedures which follow. Refer to engine service manuals and technical bulletins when mounting engines. Lift engine (block) with crane or hoist until even with head of engine stand. Bolt through adjustable fingers to back of block at bell housing mounting holes. Fasten securely to mounting plate. Slowly lower crane or hoist so that the engine stand supports full weight of engine. To check engine balance, carefully loosen hex bolt at back of rotating head, making sure stand is secured from tipping, and turn handle to rotate engine. If balance is not satisfactory, rotate engine to its original position and raise with crane or hoist just enough to take weight off the stand. Loosen bolts on adjustable fingers and realign so that weight is evenly distributed. Tighten all bolts securely and recheck balance. For safe and secure operation: do not rotate engine more than 90° for any one location of the positioning handle. In general, keep the handle within 45° of horizontal. Keep a firm hold on positioning handle while rotating engine. To remove an engine from stand, attach a crane or hoist and raise engine just enough to take engine weight off stand. Carefully remove bolts attaching fingers to engine. Be aware that there will be a slight movement of stand as total engine weight is transferred to crane.

## Inspection:

Visual inspection should be made before each use of the engine stand, checking for damaged, loose or missing parts. Each stand must be inspected by a manufacturer's repair facility immediately, if accidentally subjected to an abnormal load or shock. Any stand which appears to be damaged in any way, found to be badly worn, or operates abnormally **MUST BE REMOVED FROM SERVICE** until necessary repairs are made by a manufacturer's authorized repair facility. It is recommended that an annual inspection of the stand be made by a manufacturer's authorized repair facility and that any defective parts, decals or warning labels be replaced with manufacturer's specified parts. A list of authorized repair facilities is available from the manufacturer.

## Maintenance:

Apply motor oil to support base wheels and casters. Apply chassis grease to mounting head hub. Rotate head to distribute grease.

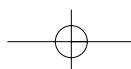

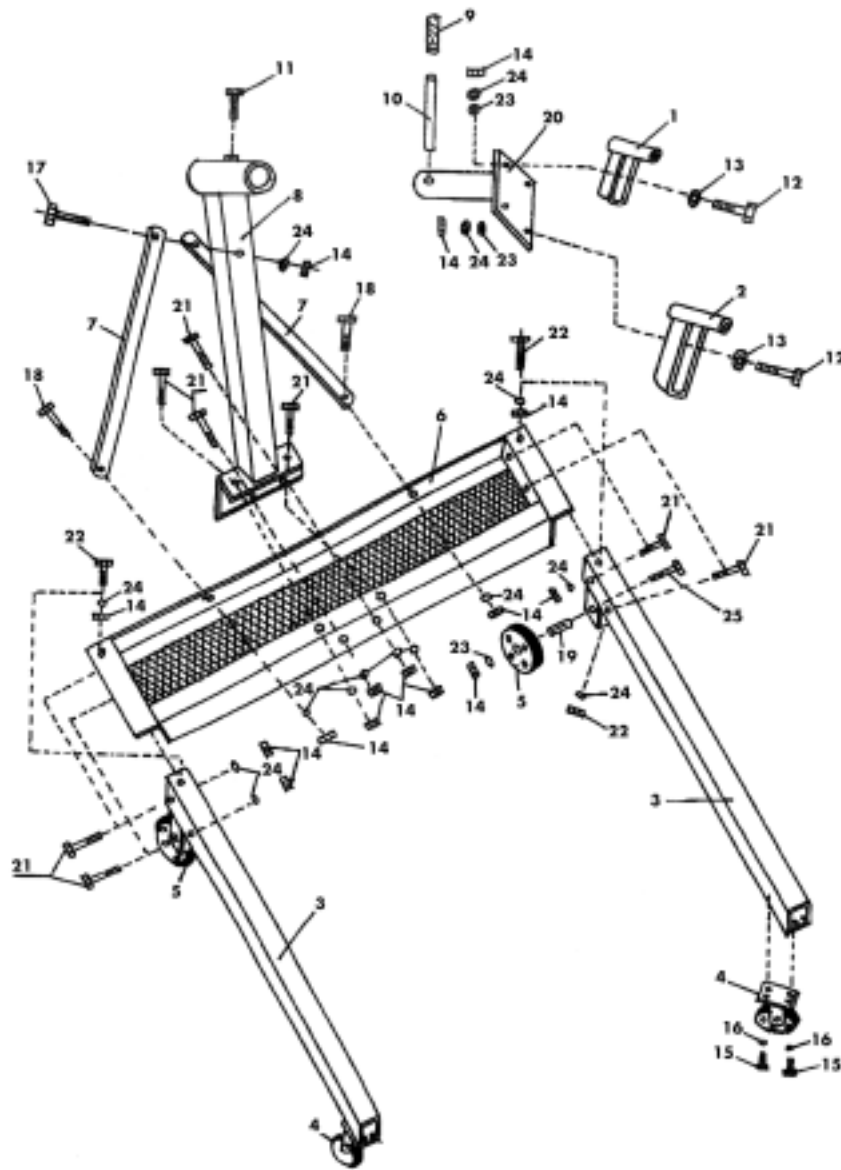

Item No.	Part No.	Description	Qty.	Item No.	Part No.	Description	Qty.
**1	RS500091	Short Finger	2	*15		5/16" x 3/4" HHCS	8
**2	RS500092	Long Finger	2	*16		5/16" Lock Washer	8
3		Base Leg	2	*17		1/2" x 3-1/2" HHCS	1
4	RSSC350A	3-1/2" Swivel Caster	2	*18		1/2" x 1-1/4" HHCS	2
5	RSW400	4" Wheel	2	*19		Shaft Jacket	2
6		Base	1	20	RS530057	Head	1
7	RS530011	Strap	2	*21		1/2" x 3-1/4" HHCS	8
8		Post	1	*22		1/2" x 1-1/4" HHCS	2
9		Handle Grip	2	*23		1/2" Lock Washer	6
10	RSESHDL	Handle (including grips)	1	*24		1/2" Washer	17
*11		1/2" x 1" HHCS	1	*25		1/2" x 2-1/2" HHCS	2
*12		1/2" x 3" HHCS	4				
*13		1/2" USS Thick Washer	4				
*14		1/2" Hex Nut	19				

\* These parts available only in bolt kit #RS8258BK (includes Item #s: 11-19 and 21-25).  
Only items identified by part number are available for purchase.

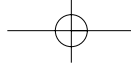

## Limited Warranty...

**SUNEX INTERNATIONAL, INC. WARRANTS TO ITS CUSTOMERS THAT THE COMPANY'S SUNEX TOOLS® BRANDED PRODUCTS ARE FREE FROM DEFECTS IN WORKMANSHIP AND MATERIALS.**

Sunex International, Inc. will repair or replace its Sunex Tools® branded products which fail to give satisfactory service due to defective workmanship or materials, based upon the terms and conditions of the following described warranty plans attributed to that specific product. This product carries a ONE-YEAR warranty. During this warranty period, Sunex Tools will repair or replace at our option any part or unit which proves to be defective in material or workmanship.

### Other important warranty information...

This warranty does not cover damage to equipment or tools arising from alteration, abuse, misuse, damage and does not cover any repairs or replacement made by anyone other than Sunex Tools or its authorized warranty service centers. The foregoing obligation is Sunex Tools' sole liability under this or any implied warranty and under no circumstances shall we be liable for any incidental or consequential damages.

**Note:** Some states do not allow the exclusion or limitation of incidental or consequential damages, so the above limitation or exclusion may not apply to you. Please contact your local Sunex distributor for proper warranty handling procedures.

If you have any questions about warranty service, please write to Sunex Tools. This warranty gives you specific legal rights and you may also have other rights which vary from state to state. Repair kits and replacement parts are available for many of Sunex Tools products regardless of whether or not the product is still covered by a warranty plan.

**Shipping Address:** Sunex Tools • 315 Hawkins Rd. • Travelers Rest, SC 29690

**Mailing Address:** Sunex Tools • P.O. Box 4215 • Greenville, SC 29608

